

# *Owner's Manual & Assembly Instructions*

*Item: ED3X61*

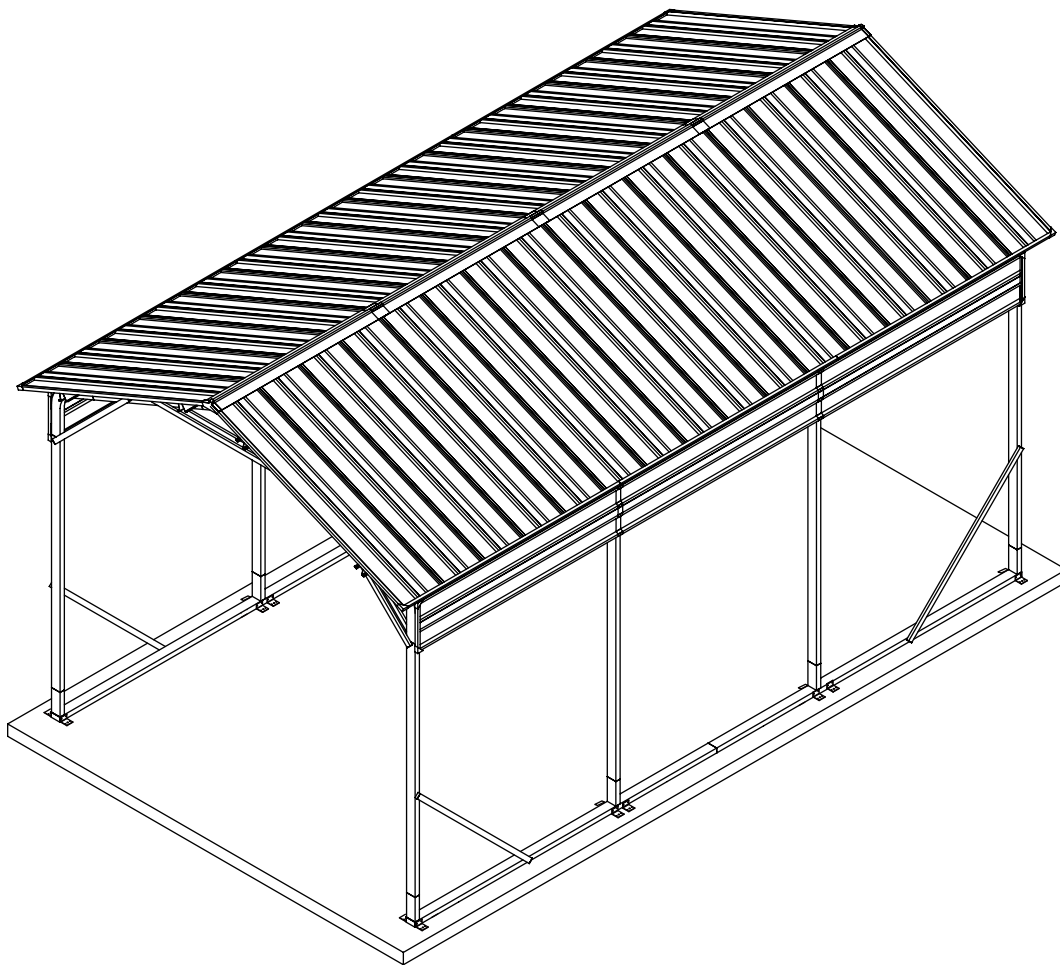

## **BUILDING DIMENSIONS**

### **ITEM: ED3X61**

Dimensions: W3.4 x D5.67 x H3.51m

Storage Area: 19.3m<sup>2</sup>. 59.9m<sup>3</sup>.

Overall size: W3.6 x D6.08 x H3.51m

**CAUTION:** SOME PARTS HAVE SHARP EDGES. CARE MUST BE TAKEN WHEN HANDLING THE VARIOUS PIECES TO AVOID A MISHAP. FOR SAFETY SAKE, PLEASE READ SAFETY INFORMATION PROVIDED IN THIS MANUAL BEFORE BEGINNING CONSTRUCTION. WEAR GLOVES WHEN HANDLING METAL PARTS.

# BEFORE YOU BEGIN

**Before commencing any assembly, read through these instructions in detail to gain a thorough understanding of assembly methods and associated details.**

**Unpack the carton(s) and carefully identify and check off all the parts against the parts described and illustrated on the following pages.**

Local Authority approval must be obtained prior to construction of the shed. Once you have selected your site you will need to lodge a site plan to local council.

**Assembly Instructions:** Instructions are supplied in this manual and contain all appropriate information for your building model. Review all instructions before you begin, and during assembly, follow the step sequence carefully for correct results.

**Parts and Parts List:** Check to be sure that you have all the necessary parts, you're your building.

- The first few steps show how to join related parts to make larger sub assemblies which will be used later.
- Familiarize yourself with the hardware and fasteners for easier use during construction.

These are packaged within the carton. Note that extra fasteners have been supplied for your convenience.

**Watch the Weather:** Be sure the day you select to install your building is dry and calm. Do not attempt to assemble your building on a windy day. Be careful on wet or muddy ground.

**Teamwork:** Whenever possible, two or more people should work together to assemble your building. One person can position parts or panels while the other is able to handle the fasteners and the tools.

**Tools and Materials:** These are some basic tools and materials you will need for the construction of your building. Decide which method of anchoring and the type of foundation you wish to use in order to form a complete list of the materials you will need.

**Note:** Metal sheets may come with plastic film to protect from scrapes during transport, for easier removal, consider using a hair dryer or hot air gun.

**Warning:** The roofing is non-trafficable unless otherwise stated. Please do not stand on them

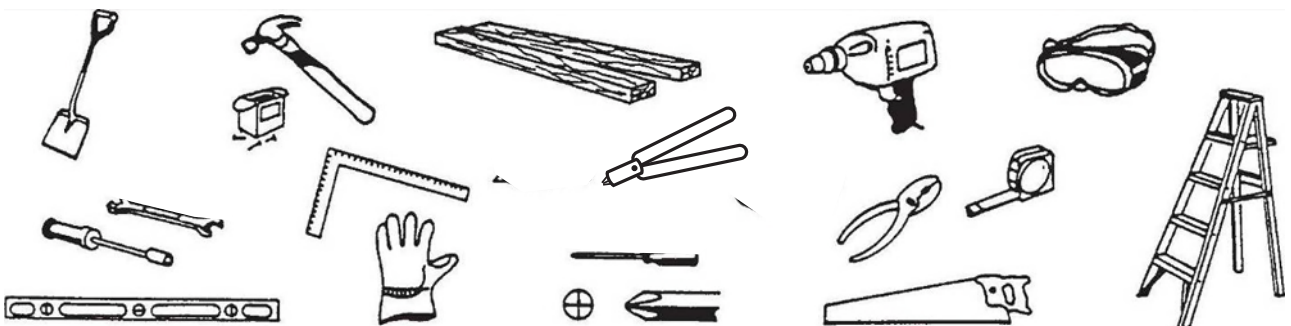

# CARE & MAINTENANCE

**Finish:** For long lasting finish, periodically clean and wax the exterior surface. Touch-up scratches as soon as you notice them on your unit. Immediately clean the area with a wire brush; wash it and apply touch-up paint per manufacturer's recommendation.

**Roof:** Keep roof clear of leaves and snow with long handled, soft-bristled broom. Heavy amounts of snow on roof can damage building making it unsafe to enter. In snow country, Roof Strengthening Kits are available for most TeachYard for added protection against heavy snow accumulation.

**Doors:** Always keep the door tracks clear of dirt and other debris that prevent them from sliding easily. Lubricate door track annually with furniture polish or silicone spray. Keep doors closed and locked to prevent wind damage

**Fasteners:** Use all washers supplied to protect against weather infiltration and to protect the metal from being scratched by screws. Regularly check your building for loose screws, bolts, nuts, etc. and retighten them as necessary.

**Moisture:** A plastic sheet (vapor barrier) placed under the entire floor area with good ventilation will reduce condensation.

## Other Tips....

- Wash off inked part numbers on coated panels with soap and water.
- Silicone caulking may be used for watertight seals throughout the building.

**Do not store swimming pool chemicals in your building. Combustibles and corrosives must be stored in air tight approved containers.**

## STEP 1: Building Foundation

**Selecting and Preparing Your Site:** Before assembly, you will want to decide on a location for your building. The best location is a level area with good drainage.

• Allow enough working space for ease of moving parts into position during assembly. Be sure there will be enough space at entrance for doors to open fully and enough space around the building to be able to fasten the panel screws from the outside.

• Before you begin the first steps in assembling your parts, a foundation should be constructed should be ready to use. The site for the shed must be level. An uneven surface may result in misalignment of parts.

### Concrete Slab (not included)

The slab should be at least 10cm thick. It must be level and flat to provide good support for the frame.

The following are the recommended materials for your foundation.

- 1 x 4's (2,5cm x 10cm) (will be removed once the concrete cures)
- Concrete
- Sheet of 6 mil plastic
- We recommend for a proper strength concrete to use a mix of:  
1 part cement • 3 parts pea sized gravel • 2 1/2 parts clean sand

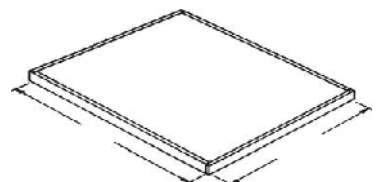

# STEP 2: Checking the Parts and Hardware

## Hardware



4x20mm screws  
410 pcs



5.5x25mm screws  
50 pcs



5.5x35mm screws  
60 pcs

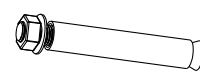

8x80mm  
24 pcs

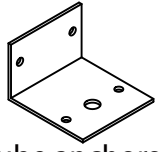

Tube anchors  
24 pcs

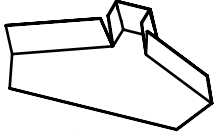

Roof end cover  
2 pcs



Corner protections  
12 pcs

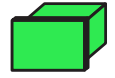

40x80 Tube covers  
4 pcs

## Parts List

Item	Name	Size	Qty.	Key
01	Roof Sheets	1950mm	32	T195
02	Wall Sheets	1920mm	6	T192
03	Tile package edge	1950mm	4	U195
04	Tile package edge	2032mm	6	U203
05	Tile package edge	410mm	4	U041
06	Roof Ridge Caps	1600mm	4	V160
07	Cross-Beams	2120mm	8	X212-N
08	Cross-Beams	1916mm	4	X192-N
09	Linker for Cross Tube	638mm	4	R134-N
10	Linker for Upstanding Tube	667mm	8	E113-N
11	Side Upstanding Tube	2210mm	8	S221-N
12	Cross Tube for roof	1268mm	8	A127-N
13	Foundation Kit	2900mm	2	H290-N
14	Foundation Kit	2850mm	2	H285-N
15	40X20 Galvanized Tube (With Tube covers)	980mm	16	X100
16	40X20 Galvanized Tube (With Tube covers)	1480mm	4	X150
17	40X20 Galvanized Tube (Without Tube covers)	1480mm	8	X150

# STEP 3: Structure drawing and Explosive view

## STRUCTURE DRAWING

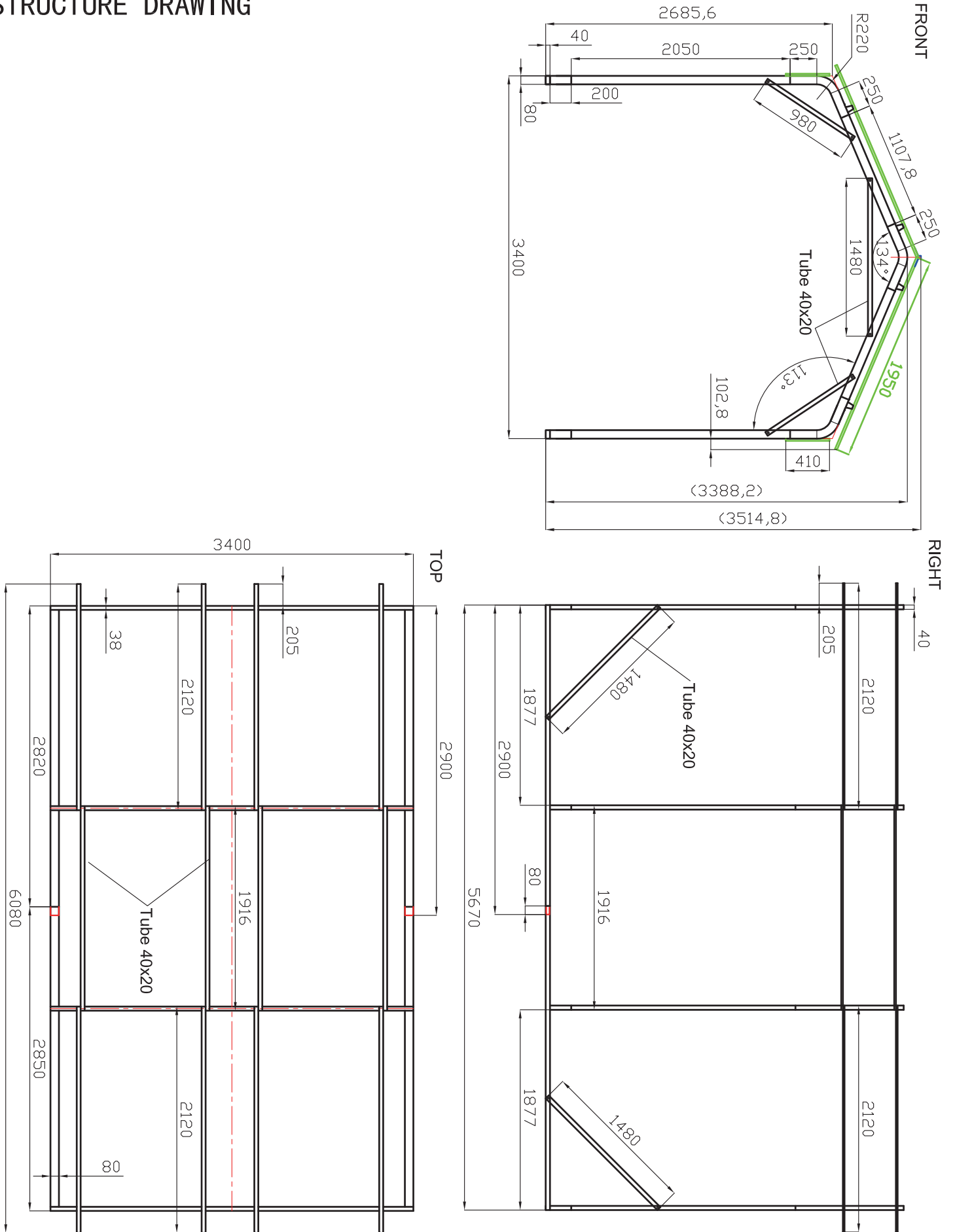

# STEP 3: Structure drawing and Explosive view

*Assembly Show Drawing*

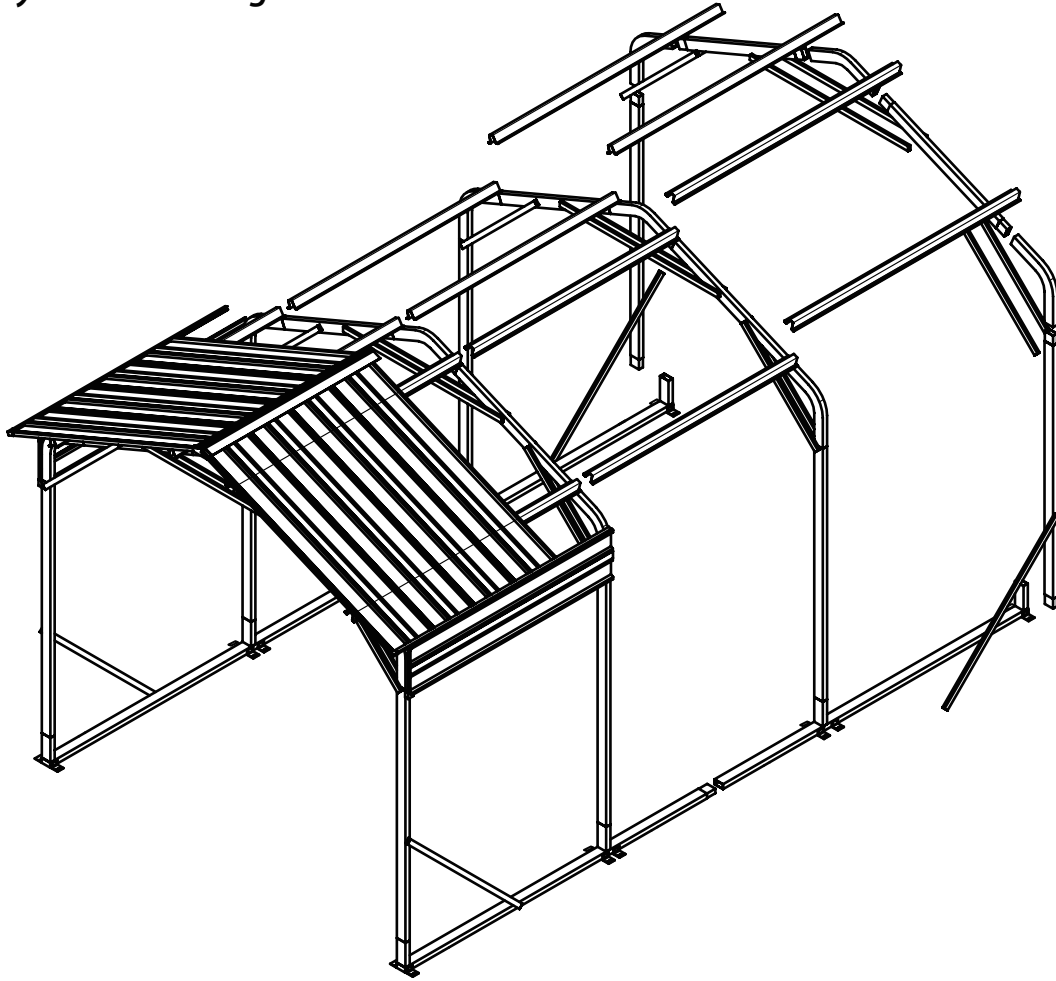

# STEP 4: Building the Foundation Kits

*Assemble the Foundation kits*



4x20mm

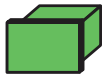

40x80 Tube covers

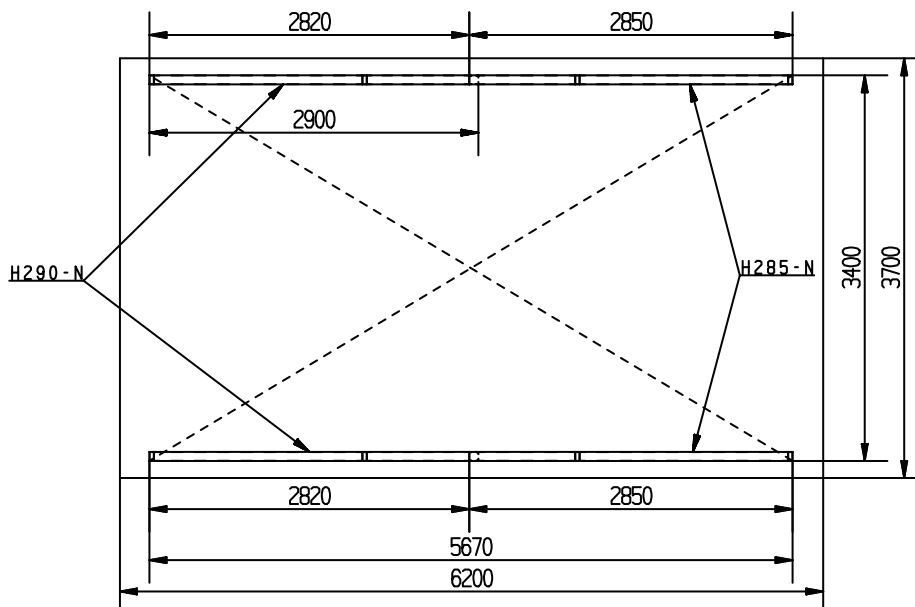

# STEP 4: Building the Side Upstanding

Please assemble all frames at flat floor.

Just Only use One Tapping Screw at all Joint area this time. In order to avoid Loosen.

PS: at the end of assembling, you can screw more to strengthen the building.

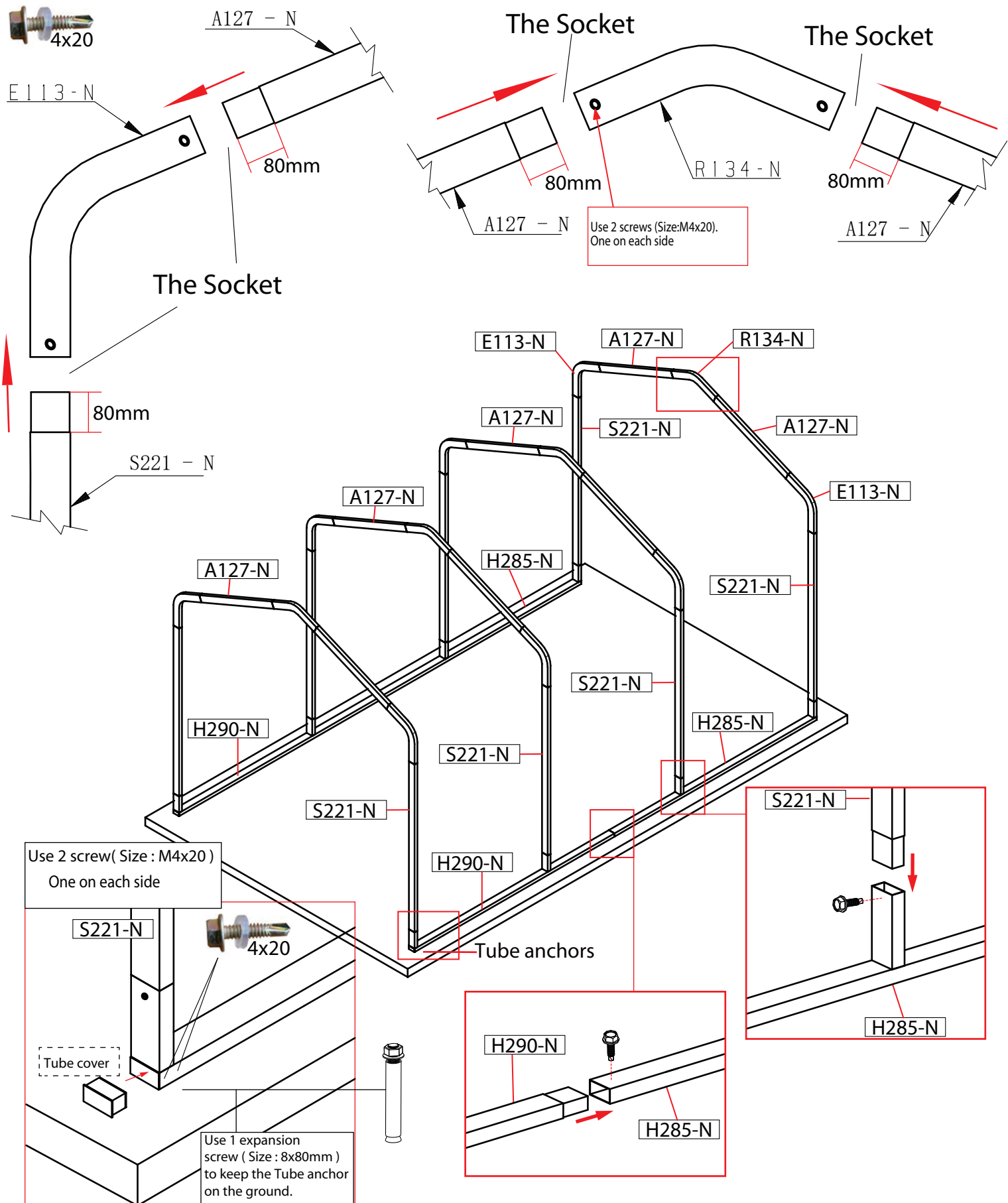

# STEP 5: Building the Roof Sheets

All the Vertical Cross Beams installed at first, and then install all support bar

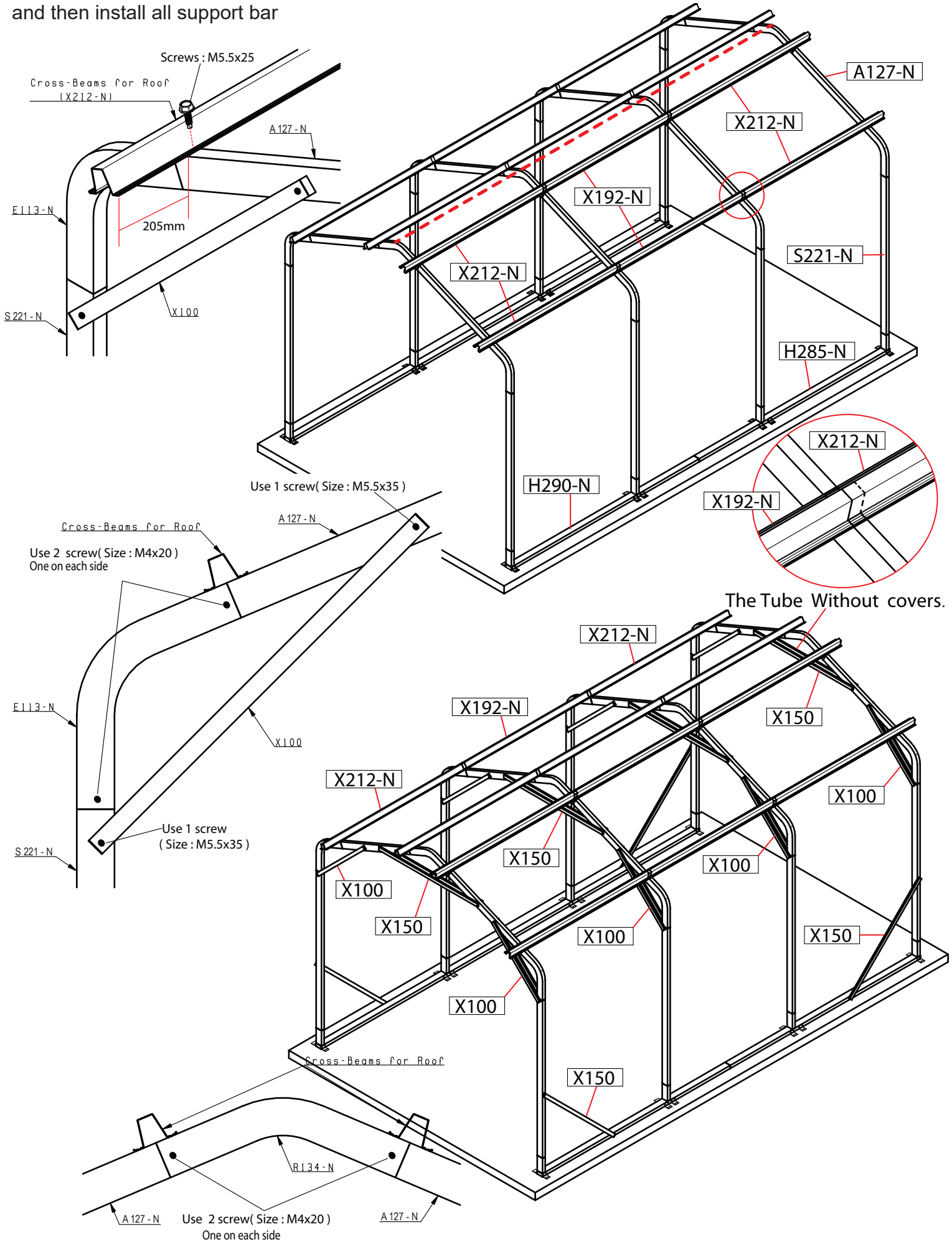

# STEP 5: Building the Roof Sheets

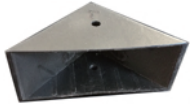

Corner protections



4x20mm screws

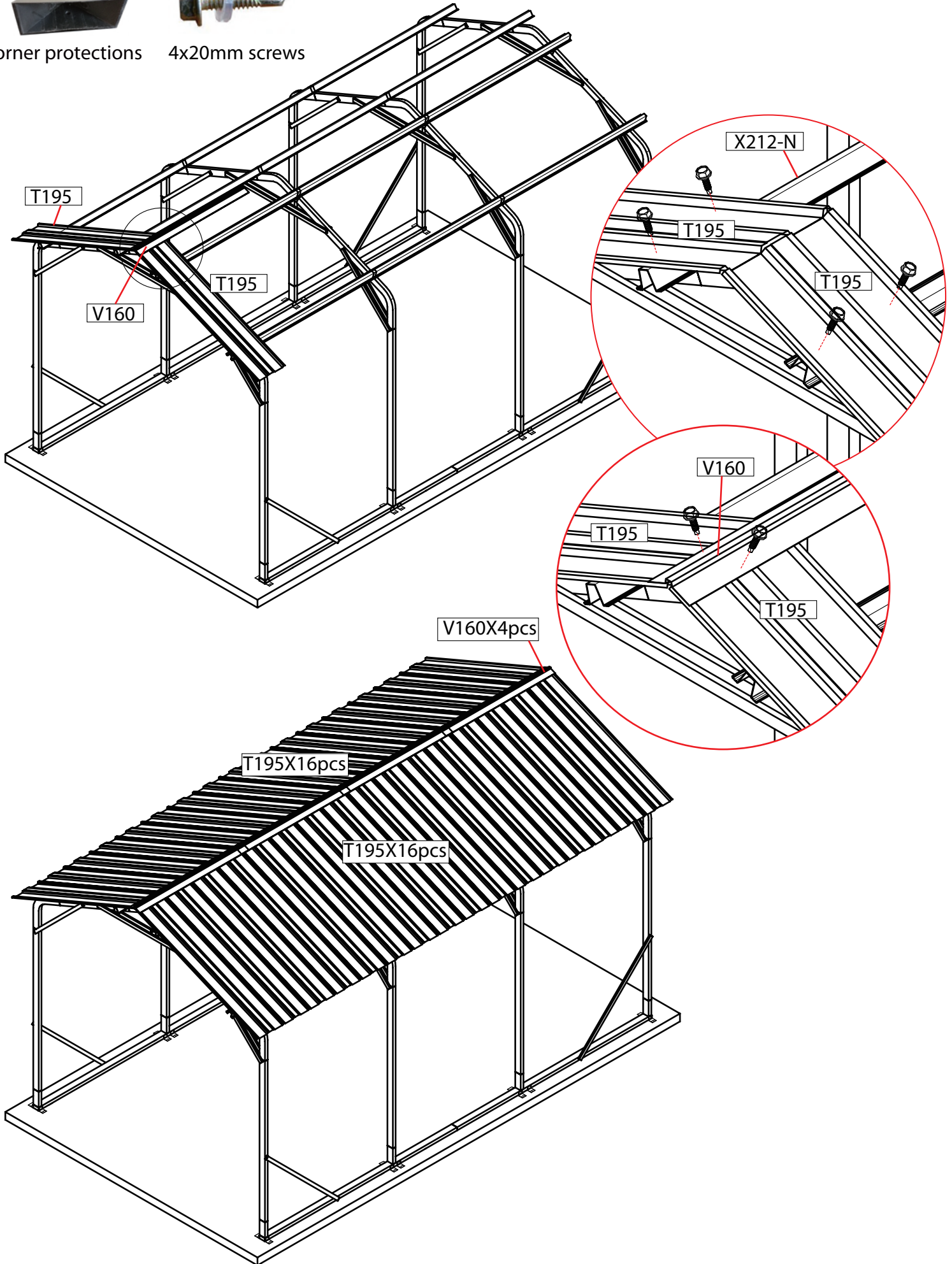

# STEP 5: Building the Roof Sheets



4x20mm screws

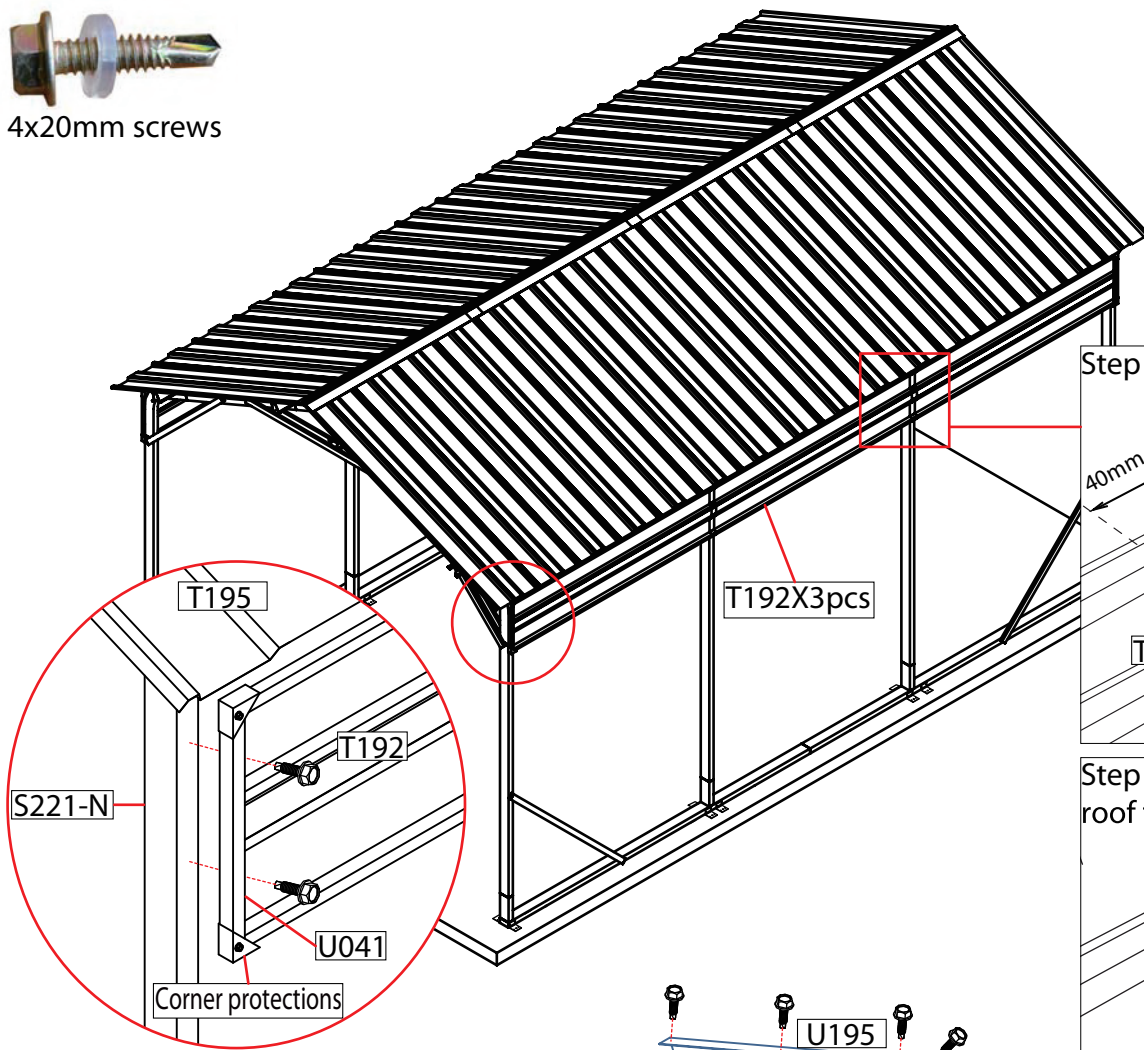

Step 1: Join the two surfaces

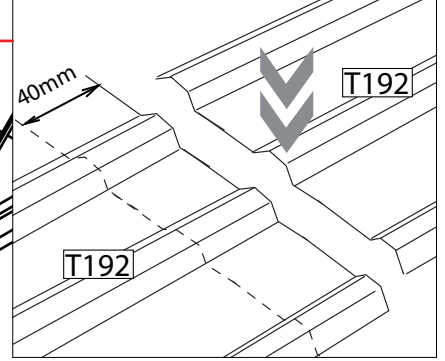

Step 2: Drill Screws in roof to fixed

